



Versatile 7-Inch TFT LCD Module 1024x600 For Embedded Systems

Our Product Introduction

for more products please visit us on chenghaolcd.com

Basic Information

- Place of Origin: China
- Brand Name: chenghao optoelectronic
- Certification: CE, ISO9001, Rose, SGS
- Model Number: CH700WS10A-CTA
- Minimum Order Quantity: 100 Pcs
- Packaging Details: All the products are packed in right way to keep it safe. For small sizes of products we use tray + carton, For bigger sizes we use foam slot + carton. we also design packages according to customers' requirements
- Delivery Time: 3~7 Days
- Payment Terms: T/T, AliPay, PayPal
- Supply Ability: 50000000 pcs/month



Product Specification

- Product Name: 7-Inch TFT LCD Module
- Backlight Luminance: 500 Cd/m2
- Display Interface: RGB
- Operating Temperature: -20 ~ +70 °C
- Display Type: 7" TFT + CTP
- Resolution: 1024*600 Dots
- Viewing Direction: 80/80/80/80
- Touch IC: GT911
- Storage Temperature: -30 ~ +80 °C
- Highlight: 7-Inch TFT LCD Module,
1024x600 TFT LCD Module,
Embedded Systems TFT LCD Module



More Images





Product Description

Product Description:

The CH700WS10A-CTA 7-inch TFT LCD touch screen module by Chenghao Optoelectronic is a versatile and advanced display solution . With a luminance of 500 cd/m2, this module ensures clear and easily readable content even in varying lighting conditions . The capacitive touch panel and I2C touch interface provide users with a responsive and interactive experience, making it ideal for applications where touch input is essential . Additionally, the module's IPS display technology offers full viewing angles, ensuring consistent image quality from different perspectives .

The module's resolution of 1024x600 dots and color depth of 16.7 million guarantee sharp and vibrant visuals for a wide range of industries and applications . Whether used in industrial control systems, medical equipment, or consumer electronics, the CH700WS10A-CTA delivers reliable performance and high-quality display capabilities . Chenghao Optoelectronic's commitment to providing innovative and market-leading display solutions is evident in the features and specifications of the CH700WS10A-CTA module . Experience the seamless integration, superior performance, and user-friendly interface of this TFT LCD touch screen module for your next project or application.

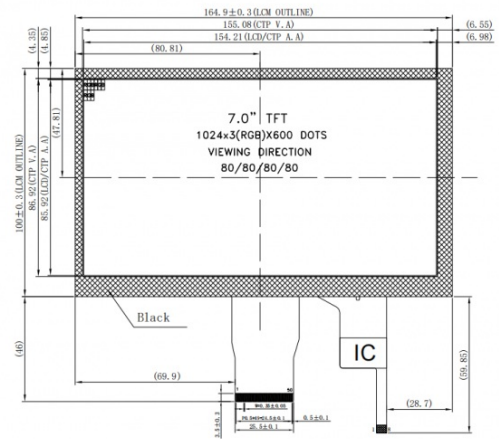

Technical Parameters:

Backlight Luminance	500 Cd/m2
Touch Type	Capacitive
Display Interface	RGB
Touch glass Lens	0.7 Mm
Resolution	1024*600 Dots
Display Mode	IPS/Transmissive/Normally Black
FPC Pin Number	50pins
Storage Temperature	-30 ~ +80 °C
Color	16M
Display Type	7" TFT + CTP

Applications:

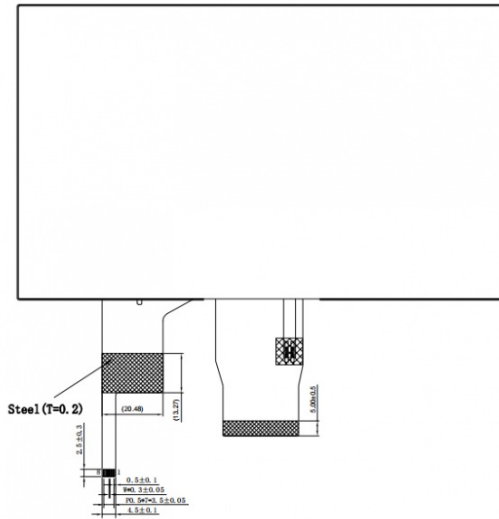

your next project or application.

The CH700WS10A-CTA 7-inch TFT LCD touch screen module by Chenghao Optoelectronic is a versatile display solution suitable for a wide range of applications. With its high resolution of 1024x600 dots and a vibrant color depth of 16.7 million, this module is well-suited for industrial control systems, medical equipment, and consumer electronics. The capacitive touch panel and I2C touch interface provide intuitive and responsive touch interactions, making it ideal for interactive displays in kiosks, information terminals, and other touch-sensitive devices. The IPS display technology of the module ensures full viewing angles, delivering consistent image quality from various perspectives, which is particularly beneficial for applications requiring wide viewing angles such as digital signage and public information displays. Moreover, the luminance of 500 cd/m² enables clear visibility even in changing lighting conditions, making it suitable for outdoor applications or environments with varying light levels. Whether deployed in industrial settings, healthcare facilities, or interactive kiosks, the CH700WS10A-CTA offers reliable performance, advanced touch capabilities, and vibrant display quality to enhance user experience and functionality across diverse industries. Experience the versatility and quality of Chenghao Optoelectronic's TFT LCD touch screen module in

About Customization:

The CH700WS10A-CTA 7-inch TFT LCD touch screen module by Chenghao Optoelectronic offers a range of customization options to meet specific project requirements. Customers can benefit from tailored solutions such as FPC redesign to ensure seamless integration into existing equipment. Additionally, backlight design customization allows for adjustments in brightness up to 2800 cd/m², catering to diverse visibility needs.

For interface flexibility, Chenghao Optoelectronic provides customization of the module interface type, supporting various options including SPI, MCU, RGB, MIPI, LVDS, HDMI, and more based on customer preferences. Touch interaction needs can be met with a choice between capacitive and resistive touch solutions, with capacitive touch solutions focusing on designing touch glass covers that align with application requirements. This ensures optimal touch sensitivity and functionality.

Whether it's adapting the FPC, enhancing backlight brightness, defining the module interface, or selecting the touch solution, Chenghao Optoelectronic's customization services empower customers to tailor the CH700WS10A-CTA module to their specific needs, ensuring seamless integration and optimal performance for a wide range of applications.

FAQ:

Here are some frequently asked questions about our TFT LCD Display:

Q: What is the brand name of this product?

A: The brand name of this product is chenghao optoelectronic.

Q: What is the model number of this product?

A: The model number of this product is CH700WS10A-CTA.

Q: Where is this product manufactured?

A: This product is manufactured in China.

Q: What certifications does this product have?

A: This product has CE, ISO9001, Rose, and SGS certifications.

Q: What is the minimum order quantity for this product?

A: The minimum order quantity for this product is 100 pcs.

Q: How is this product packaged?

A: All the products are packed in the right way to keep them safe. For small sizes of products, we use tray + carton. For bigger sizes, we use foam slot + carton. We also design packages according to customers' requirements.

Q: What is the delivery time for this product?

A: The delivery time for this product is 3~7 days.

Q: What are the payment terms for this product?

A: The payment terms for this product are T/T, AliPay, and PayPal.

Q: What is the supply ability for this product?

A: The supply ability for this product is 50000000 pcs/month.



Shenzhen ChengHao Optoelectronic Co., Ltd.



+86 755-27806536



add@chenghaolcm.com



chenghaolcd.com

7th floor, building C5, Hengfeng Industrial City, Hangcheng street, Bao'an District, Shenzhen