



800*600 Resolution TFT Lcd Capacitive Touchscreen 900 Nits High Brightness 8" With LT7381

Our Product Introduction

for more products please visit us on chenghaolcd.com

Basic Information

- Place of Origin: China Shenzhen
- Brand Name: Chenghao Optoelectronic
- Certification: CE RoHS FCC
- Model Number: CH800SV01A-CT-PB
- Minimum Order Quantity: 100 pcs
- Packaging Details: All the products are packed in right way to keep it safe. For small sizes of products we use tray + carton, For bigger sizes we use foam slot + carton. we also design packages according to customers' requirements
- Delivery Time: 3~7 Days
- Payment Terms: TT or Others
- Supply Ability: 50000000 pcs/month



Product Specification

- Product Name: TFT Lcd Capacitive Touchscreen
- FPC Pin Number: 40 Pins
- Display Operating Temp: -20 ~ +70°C
- Color: 16M
- Display Contrast Ratio: 800:1
- Display Size: 8 Inch
- Touch Interface: I2C
- Display Life Span: 50000H
- Module Type: 8"TFT +CTP+PCB
- Highlight: 800*600 Resolution TFT Lcd Capacitive Touchscreen
, 8" TFT Lcd Capacitive Touchscreen,
900 Nits TFT Lcd Capacitive Touchscreen



More Images





Product Description

Product Description:

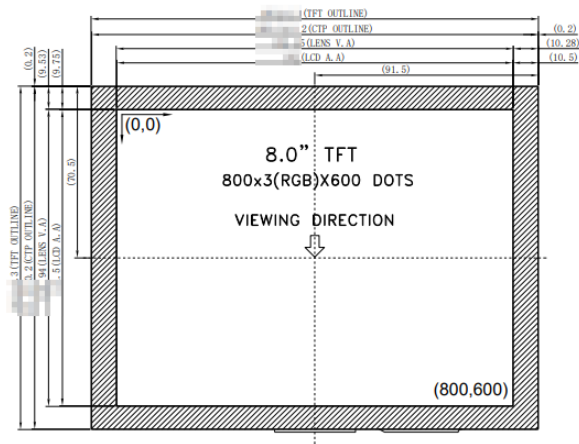

The CH800SV01A-CT-PB LCD display module boasts an 8-inch display size, providing ample viewing space for your content. With a 16M color depth, you can expect vivid and accurate colors that showcase your content in the best light. Whether you are displaying images, videos, or text, this display will provide crisp, clear visuals that are sure to impress.

This LCD display module is designed to operate in a wide range of temperatures, making it a reliable choice for both indoor and outdoor applications. The display has an operating temperature range of -20 ~ +70°C and a storage temperature range of -30 ~ +80°C. This sunlight-readable LCD display is ideal for outdoor applications as it is designed to remain visible even in bright sunlight.

In summary, our 8-inch LCD display module is an excellent choice for any application that requires a high-quality visual display.

Features:

Product Name: LCD Display Module
FPC Pin Number: 40 Pins
Storage Temperature: -30 ~ +80°C
Display Mode: TN/Transmissive/Normally White
Module Type: 8"TFT +CTP+PCB
Display Brightness: 900 Cd/m2
Module Interface:SPI+RGB+MCU

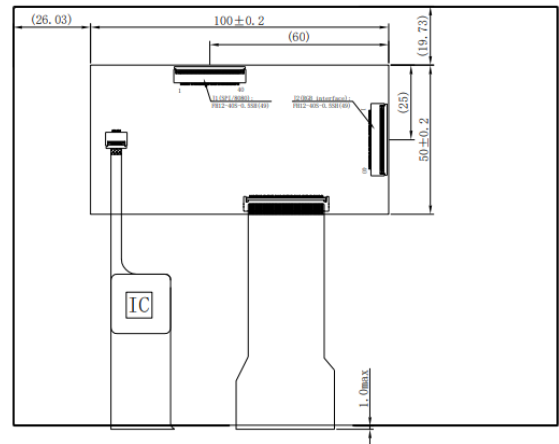

Technical Parameters:

Technical Parameter	Value
Product Name	Active Matrix Display Module
Display Size	8 Inch
Display Resolution	800*600 Dots
Display Brightness	900 Cd/m2

Display Contrast Ratio	800:1
Display Viewing Angle	12:00
Touch Interface	I2C
FPC Pin Number	40 Pins
Display Operating Temp	-20 ~ +70°C
Storage Temperature	-30 ~ +80°C
Display Life Span	50000H

Applications:

This LCD Display Module is suitable for a wide range of applications and scenarios. Its sunlight readable lcd display feature makes it perfect for outdoor use, where it can withstand bright sunlight and still display clear images. It is ideal for use in industrial control systems, medical equipment, and transportation systems.

The Liquid Crystal Display Panel can be used in advertising display screens, gaming machines, and vending machines. It is also perfect for use in digital signage, where it can display clear and bright images in various lighting conditions.

The LCD Display Module can be used in retail stores, where it can be used to display prices and promotions. It is also suitable for use in museums and art galleries, where it can display information about exhibits and artwork.

Overall, Chenghao Optoelectronic's LCD Display Module is a versatile and high-quality product that can be used in a wide range of applications and scenarios. Its sunlight readable lcd display feature, along with its other impressive attributes, makes it a popular choice among customers.



FAQ:

Q1. What is the brand name of this LCD Display Module?

A1. The brand name of this LCD Display Module is Chenghao Optoelectronic.

Q2. What is the model number of this LCD Display Module?

A2. The model number of this LCD Display Module is CH800SV01A-CT-PB.

Q3. Where is this LCD Display Module manufactured?

A3. This LCD Display Module is manufactured in China, Shenzhen.

Q4. Does this LCD Display Module have any certifications?

A4. Yes, this LCD Display Module has CE, RoHS, and FCC certifications.

Q5. What is the minimum order quantity for this LCD Display Module?

A5. The minimum order quantity for this LCD Display Module is 100 pcs.

Q6. How is this LCD Display Module packaged?

A6. All the products are packed in the right way to keep them safe. For small sizes of products, we use tray + carton, for bigger sizes, we use foam slot + carton. We also design packages according to customers' requirements.

Q7. What is the delivery time for this LCD Display Module?

A7. The delivery time for this LCD Display Module is 3~7 days.

Q8. What are the payment terms for this LCD Display Module?

A8. The payment terms for this LCD Display Module are TT or others.

Q9. What is the supply ability for this LCD Display Module?

A9. The supply ability for this LCD Display Module is 50000000 pcs/month.



Shenzhen ChengHao Optoelectronic Co., Ltd.



+86 755-27806536



add@chenghaolcm.com



chenghaolcd.com

7th floor, building C5, Hengfeng Industrial City, Hangcheng street, Bao'an District, Shenzhen

