



800x600 Resolution LCD Touch Screen 10.4" with I2C Interface for Commercial Applications

Our Product Introduction

for more products please visit us on chenghaolcd.com

Basic Information

- Place of Origin: China Shenzhen
- Brand Name: Chenghao Optoelectronic
- Certification: RoHS CE FCC
- Model Number: CH104SV01A-CT-PB
- Minimum Order Quantity: 100 pcs
- Packaging Details: All the products are packed in right way to keep it safe. For small sizes of products we use tray + carton, For bigger sizes we use foam slot + carton. we also design packages according to customers' requirements
- Delivery Time: 3~7 Days
- Payment Terms: TT
- Supply Ability: 300K pcs/month



Product Specification

- Product Name: LCD Touch Screen
- Display Mode: TN/Normally White/Transmissive
- FPC Pin Numbers: 40 Pins
- Operating Temperature: -20°C~70°C
- Resolution: 800x600 Pixels
- Touch Type: Capacitive
- Touch Panel Interface: I2C
- Luminance: 800 Cd/m2
- Storage Temperature: -30°C~80°C
- Highlight: Commercial Applications LCD Touch Screen, 800x600 LCD Touch Screen

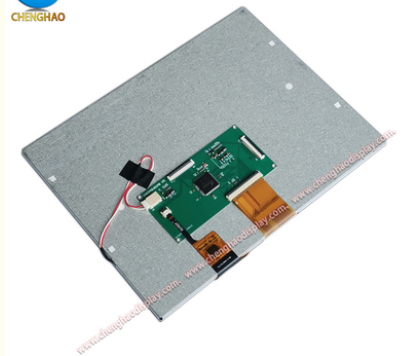

More Images



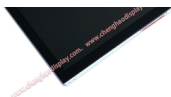

Product Description

Product Description:

Chenghao Display model CH104SV01A-CT-PB is a liquid crystal display module that utilizes amorphous silicon TFT as a switching device. This module contains a touch panel, LCD display screen, and PCB board. The LCD display screen, in particular, is composed of a touch panel, a TFT LCD panel, a driving IC, a back-light, and FPC. The active display area of this LCD display module is 10.4 inches. After receiving R.G.B. signal, it produces images in 16.7M colors and at a resolution of 800*600 pixels. The display employs TN/Transmissive/Normally White display mode and has a preferred viewing angle of 12 o'clock. It can operate steadily within a temperature range of -20 ~ +70°C and is compatible with other interfaces such as SPI, RGB, and MCU. The touch panel is a capacitive touch glass cover that is equipped with a control chip model GT9271. This chip facilitates communication with external devices via the I2C interface and supports multi-touch. Furthermore, the glass cover is 1.1 mm thick and can be customized as per the customer's requirements. This LCD display module is RoHS compliant and halogen-free, making it an eco-friendly option for various applications.

Features:

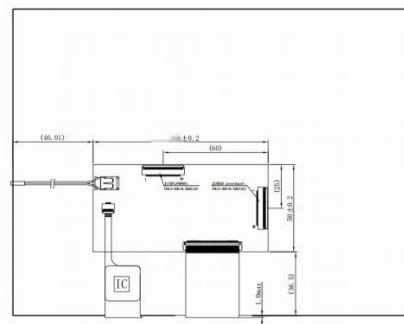
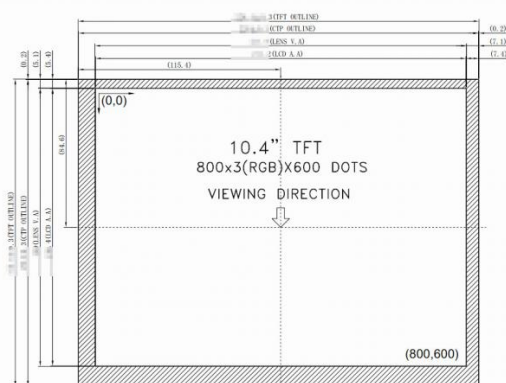

Customized LCD Display - Chenghao Display CH104SV01A-CT-PB
Chenghao Display has launched the CH104SV01A-CT-PB, a customized LCD display with excellent cost-performance ratio. This display module is designed to meet the needs of various industries and applications.

A major feature of this LCD display is its wide temperature design. It can operate smoothly in a temperature range as low as -20°C and as high as +70°C, which is very suitable for applications that need to operate in extreme environmental conditions. This feature is particularly useful for machines and equipment used in harsh environments.

Another major feature of the CH104SV01A-CT-PB is that it supports human-computer interaction. The display module is equipped with a sensitive capacitive touch glass panel to collect customer touch information. Through the touch panel, users can input information into the display and receive screen control feedback from other components. The display module thus provides simple and intuitive human-computer interaction.

Technical Parameters:

Module No	CH104SV01A-CT-PB	--
Module Type	10.4" TFT+CTP+PCB	--
Resolution	800*600	dots
Display Mode	TN/Transmissive/Normally White	--
Viewing Direction	12:00	--
Brightness	800	cd/m2
Contrast	500	--
Color	16.7	M
Touch Type	Capacitive	--

Operating Temperature	-20 ~ +70	°C
-----------------------	-----------	----

Applications:

Chenghao Display CH104SV01A-CT-PB is a 10.4 inch LCD display module that has been specifically designed and customized for use with industrial equipment. The display module has several functional parameters that can be modified and adjusted according to customer specifications, making it a highly versatile option for a variety of applications. Its flexibility and adaptability make it an ideal choice for various industries, including but not limited to home appliances, automobile transportation, Internet of Things equipment, medical equipment and other fields that require a high-performance display module. The display module is well-suited for a variety of industrial applications, thanks to its rugged construction and reliable performance under extreme conditions.



FAQ:

Q: What is the brand name of this product?

A: The brand name of this product is Chenghao Optoelectronic.

Q: What is the model number of this product?

A: The model number of this product is CH104SV01A-CT-PB.

Q: Where is this product manufactured?

A: This product is manufactured in China Shenzhen.

Q: What certifications does this product have?

A: This product has RoHS, CE, and FCC certifications.

Q: What is the minimum order quantity for this product?

A: The minimum order quantity for this product is 100 pcs.

Q: How is this product packaged?

A: All the products are packed in the right way to keep them safe. For small sizes of products, we use tray + carton, and for bigger sizes, we use foam slot + carton. We also design packages according to customers' requirements.

Q: What is the delivery time for this product?

A: The delivery time for this product is 3~7 days.

Q: What are the payment terms for this product?

A: The payment terms for this product are TT.

Q: What is the supply ability of this product?

A: The supply ability of this product is 300K pcs/month.



Shenzhen ChengHao Optoelectronic Co., Ltd.



+86 755-27806536



add@chenghaolcm.com



chenghaolcd.com

7th floor, building C5, Hengfeng Industrial City, Hangcheng street, Bao'an District, Shenzhen